

Squires Gate, Gunthorpe, Peterborough, PE4 7BT.



Lounge



Kitchen



Bedroom



Bathroom



Enclosed Rear Garden



Energy Performance Certificate

Draft details only may be subject to amendment
None of the statements/measurements in these particulars should be relied on as representations of fact.
Any applications/services mentioned should not be taken as a guarantee that they are in working order.

Harrison Rose

Estate Agents Ltd

FOR SALE



Semi-detached, two bedroom home located in Gunthorpe.
Squires Gate, Gunthorpe, Peterborough, PE4 7BT.

- WELL PRESENTED
- SEMI-DETACHED HOME
- TWO BEDROOMS
- ENCLOSED REAR GARDEN
- OFF ROAD PARKING

£169,995



T: 01733 202525 | info@harrisonroseproperty.com | F: 01733 202962

Ref: 1653

www.harrisonroseproperty.com

Ground Floor

Porch

Entrance door, door to:

Lounge/Diner 5.82m (19'1") x 3.54m (11'7")

Laminate flooring, TV and telephone point, two uPVC double glazed windows to front, stairs leading to landing, door to:

Kitchen 3.54m (11'7") x 2.39m (7'10")

Fitted with a matching range of base and eye level units with worktop space over, sink with mixer tap, built-in electric double oven, four ring gas hob with extractor hood over, space for fridge and washing machine, uPVC double glazed window to rear, door to rear garden.

First Floor

Landing

Access to loft, doors to:

Bedroom 1 3.63m (11'11")max x 3.56m (11'7")max

UPVC double glazed window to rear, built-in storage cupboard, radiator, telephone point, door to built-in storage cupboard.

Bedroom 2 3.54m (11'7") x 2.65m (8'8")

Three uPVC double glazed windows to front, single radiator, TV point.

Bathroom

Fitted with a three piece suite comprising a bath with shower attachment, pedestal wash hand basin and low-level WC, heated towel rail, uPVC frosted double glazed window to side.

Outside

The front of the property is mainly laid to gravel allowing for off road parking for two cars, pathway leading to front entrance door and leading to side gate. Enclosed rear garden, mainly laid to lawn with a patio area, access to Summer house allowing for further seating area, shed to the rear and further shed to the front, decorative slate chippings to border.

Draft details only may be subject to amendment
None of the statements/measurements in these particulars should be relied on as representations of fact.
Any applications/services mentioned should not be taken as a guarantee that they are in working order.

- Call today to arrange your free valuation -

Ground Floor

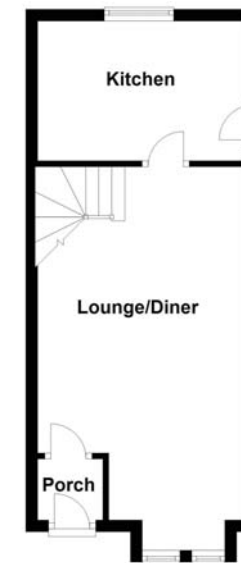

First Floor

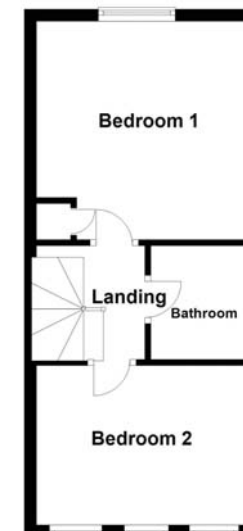

This floorplan has been drawn for illustration purposes only. Prospective purchasers should seek independent confirmation.

- To arrange a viewing, please call us 01733 202525 -