

Welland Road, Dogsthorpe, Peterborough, PE1 3SZ.



Kitchen



Lounge



Bedroom



Rear Aspect



Garden

Energy Efficiency Rating		Environmental (CO ₂) Impact Rating	
Current	Potential	Current	Potential
68	85	68	85

Energy Performance Certificate

Energy Performance Certificate

Draft details only may be subject to amendment
None of the statements/measurements in these particulars should be relied on as representations of fact.
Any applications/services mentioned should not be taken as a guarantee that they are in working order.

Harrison Rose

Estate Agents Ltd

FOR SALE



Ideal first time buyers/investment home in Peterborough.

Welland Road, Dogsthorpe, Peterborough, PE1 3SZ.

- SEMI-DETACHED HOME
- TWO BEDROOMS
- TWO STORE ROOMS
- NO FORWARD CHAIN
- GARAGE & OFF ROAD PARKING

£150,000



T: 01733 202525 | info@harrisonroseproperty.com | F: 01733 202962

Ref: 1130

www.harrisonroseproperty.com

Ground Floor

Hall

Front entrance door, single radiator, stairs leading to the first floor landing, door leading to:

Lounge 4.89m (16'1") x 3.54m (11'8")

TV point, dado rail, coving to textured ceiling, gas fireplace, sliding doors leading to the garden.

Kitchen 3.43m (11'3") x 2.42m (7'11")

Fitted with a matching range of base and eye level units with worktop space over cupboards and drawers, sink with mixer tap, tiled surround, space for fridge, washing machine and cooker, uPVC double glazed window to front, uPVC double glazed window to side, single radiator, tiled flooring, coving to textured ceiling, folding door leading to the WC and further doors to the store rooms.

WC

UPVC frosted double glazed window to side.

Store Room 2.36m (7'9") x 1.47m (4'10")

UPVC double glazed window to rear, door to:

Store Room 2.36m (7'9") x 1.47m (4'10")

Door leading to the front and rear of the property, access to built in cupboard.

First Floor

Landing

UPVC double glazed window to front, coving to textured ceiling, access to loft, built in storage cupboard, door leading to:

Bedroom 1 3.71m (12'2") x 3.35m (11')

UPVC double glazed window to rear, single radiator, laminate flooring, coving to textured ceiling, built in sliding door wardrobes.

Bedroom 2 3.71m (12'2") x 2.62m (8'7")

UPVC double glazed window to rear, single radiator, laminate flooring, coving to textured ceiling, built in sliding door wardrobes.

Shower Room

Fitted with a three piece suite, comprising a shower enclosure, pedestal wash hand basin, WC, extractor fan, fully tiled, uPVC double glazed window to front and side, single radiator.

Outside

The front of the property is enclosed via a brick wall, gravelled area to the side with a path leading to the front entrance door. Generously sized rear garden, mainly laid to lawn with a patio area, mixed plants, trees and shrubs, access to the garage and off road parking located to the side of the property.

Draft details only may be subject to amendment
None of the statements/measurements in these particulars should be relied on as representations of fact.
Any applications/services mentioned should not be taken as a guarantee that they are in working order.

- Call today to arrange your free valuation -

Ground Floor



First Floor

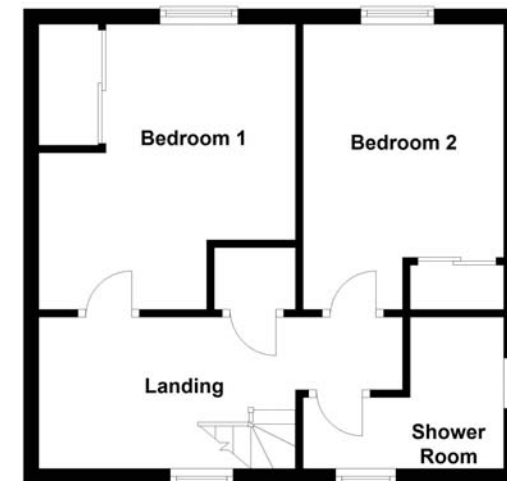

- To arrange a viewing, please call us 01733 202525 -